



2025 IADI

Ad hoc Executive Council Meeting
and Core Principles Conference

9th-12th September 2025

INFORMATION KIT





Contents

Welcome Message	2
Quick Guide.....	3
Meeting Venue.....	6
VISA Information.....	10
Accommodation	12
Social Events.....	14
Excursion.....	17
Travel to Taipei	20
Discover Taipei	23

Welcome Message

Dear IADI Members and Distinguished Guests,

On behalf of the Central Deposit Insurance Corporation – Chinese Taipei (CDIC), it is my great honor and pleasure to warmly welcome you to Taipei for the IADI Ad hoc Executive Council Meeting and the Core Principles International Conference, to be held in September 2025.

We are privileged to host this important event at a pivotal moment for the IADI. The primary objective of this meeting is to finalize and approve the revised IADI Core Principles for Effective Deposit Insurance Systems by the Executive Council, in preparation for their endorsement at the 2025 IADI Annual General Meeting. In conjunction, an international conference on the Core Principles will provide a valuable forum for the exchange of insights and professional perspectives on this global standard for deposit insurance. These efforts reflect our shared commitment to strengthening the global financial safety net and promoting depositor protection through international collaboration and policy coherence.

The Core Principles remain the cornerstone for the design, implementation, and assessment of deposit insurance systems across jurisdictions. Ensuring their continued relevance amid an ever-evolving financial landscape is vital to reinforcing public confidence and safeguarding financial stability.

CDIC is proud to support this important endeavour and to offer a platform for constructive dialogue and cooperation among IADI members. We look forward to productive discussions and a successful outcome that will mark a significant milestone in the evolution of deposit insurance systems worldwide.

I sincerely extend my appreciation for your active participation and look forward to welcoming you to Taipei this September.

Sincerely yours,

A handwritten signature in black ink, reading 'Tien-Mu Huang'.

Tien-Mu Huang
Chairman
Central Deposit Insurance Corporation, Chinese Taipei

Quick Guide

2025 IADI Ad hoc Executive Council Meeting and Core Principles International Conference hosted by Central Deposit Insurance Corporation, Chinese Taipei.

 Dates: Tuesday, 9th September – Friday, 12th September 2025

 Main Venue: Grand Hyatt Taipei

Address: No. 2, Songshou Road, Xinyi District, Taipei City, Taiwan

Registration Information

Date	Time	Reception
9/8 (Mon)	16:00-20:00	Near the East Entrance of the Lobby floor
9/9 (Tue)	08:00-16:30	Entrance of the meeting venue
9/9 (Tue)	16:30-22:00	Front of Magpie Room 3F of Grand Hyatt Taipei
9/10 (Wed)	08:00-12:00	Entrance of the meeting venue
9/10 (Wed)	12:00-22:00	Front of Magpie Room 3F of Grand Hyatt Taipei
9/11 (Thu)	08:00-20:00	Entrance of the meeting venue

Floor plan of the Lobby floor of the Grand Hyatt Taipei

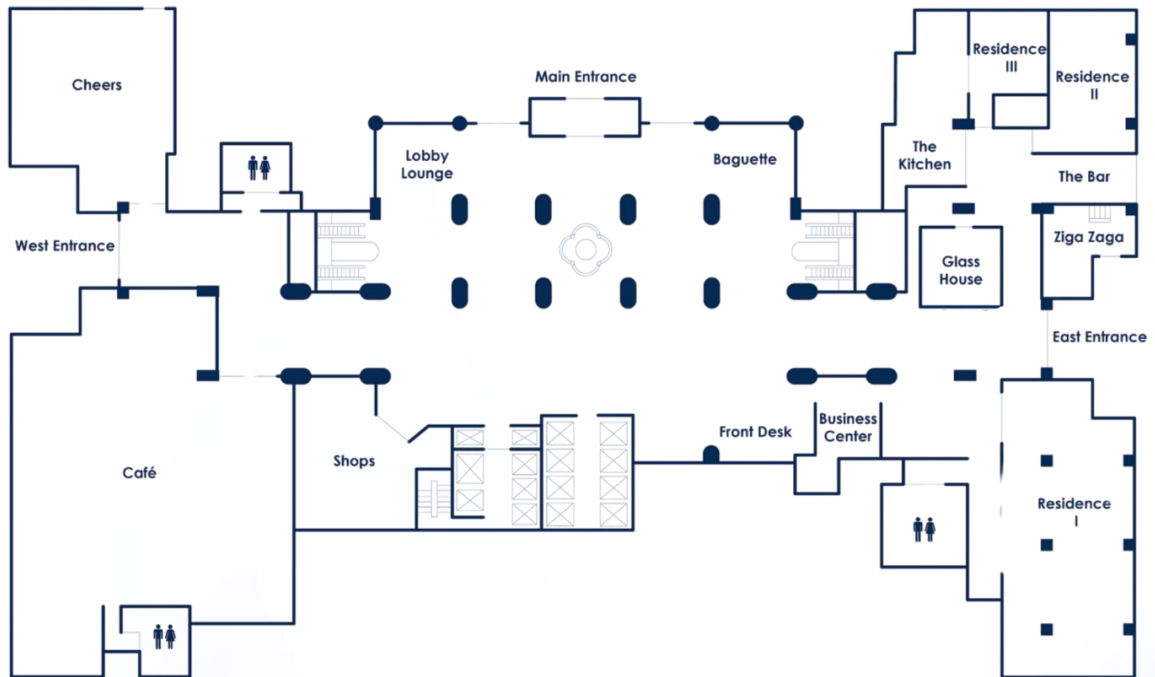

Floor plan of the 3F of the Grand Hyatt Taipei

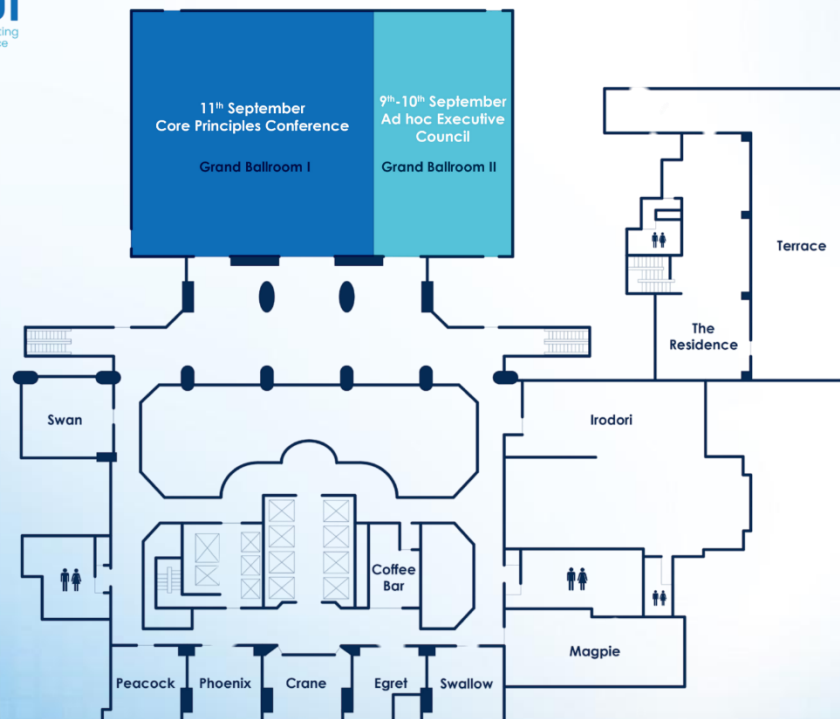

◆ Social Events Overview

Date	Event	Venue
9/9 (Tue)	Exclusive Cocktail Reception	YEN Bar (31F of W Taipei)
9/10 (Wed)	Welcome Dinner	Shangri-La Ballroom (2F of Shangri-La Far Eastern Taipei)
9/11 (Thu)	Farewell Dinner	Grand Ballroom I (3F of Grand Hyatt Taipei)

☎ Contact Information

Secretariat of 2025 IADI Taipei Events

☎ Phone: +886 2 8780-5688 ext. 161 / +886 2 2397-1155 ext. 222

✉ Email: secretariat@iadi2025taipei.org / irr@cdic.gov.tw

Meeting Venue



It is our pleasure to invite you to attend the 2025 Ad hoc Executive Council Meeting and Core Principles International Conference (IADI 2025), which will take place from September 9th to 12th, 2025, at the Grand Hyatt Taipei.

Address: No. 2, Songshou Road, Taipei 110061, Taiwan

Grand Hyatt Taipei, located right next to the world-famous landmark **Taipei 101** with a connecting bridge, is directly adjacent to **Taipei World Trade Center** and **Taipei International Convention Center** as part of the **World Trade Center complex** in the **Xinyi District**, Taipei' s most cosmopolitan and affluent neighborhood.

The Xinyi District boasts a tapestry of upscale eateries, shopping arcades, entertainment complexes, and vibrant night markets, making it a favored tourist destination. Two MRT/Subway stations and over 30 bus routes surrounding the hotel offer guests easy access to the city' s most scenic spots.

Day 1 & Day 2 9th-10th September Ad hoc Executive Council

Venue: Grand Ballroom II, 3F of Grand Hyatt Taipei

Day 3 11th September Core Principles International Conference

Venue: Grand Ballroom I, 3F of Grand Hyatt Taipei

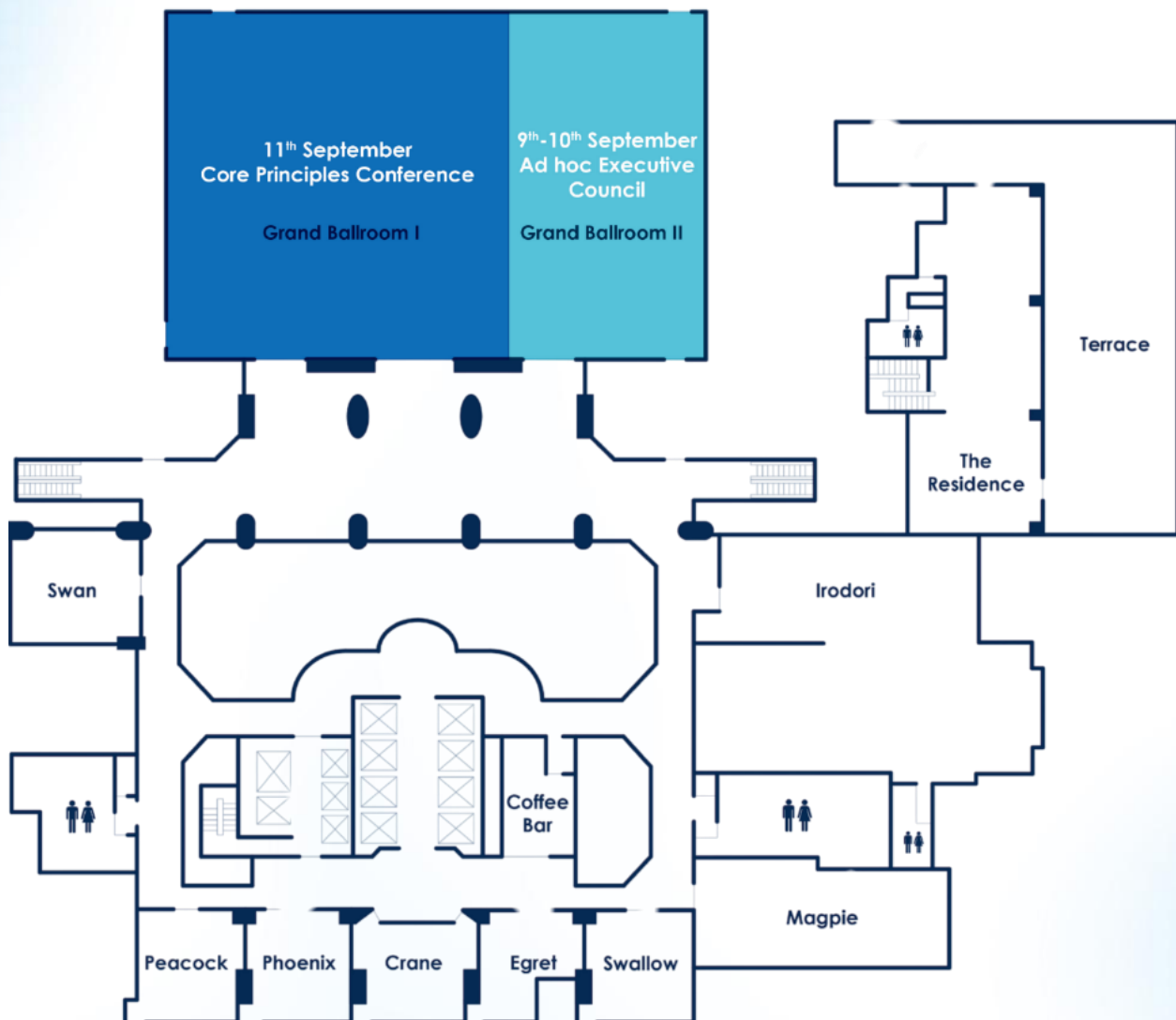

Floor Plan: 3F of Grand Hyatt Taipei

Transportation

From Taoyuan International Airport (TPE)

- **Taoyuan Airport MRT:** The Taoyuan Airport MRT connects with Taipei Metro system at Taipei Main Station. Guests can transfer to the Tamsui-Xinyi Line (Taipei Metro) and get off at Taipei 101 / World Trade Center Station – Exit 5.
- **Airport Bus:** Air Bus 1960 offers a transit service between the airport and Grand Hyatt Taipei daily.
 - Taoyuan Airport Terminal 1 bus pickup point: Bus pickup zone at B1 arrivals lobby.
 - Taoyuan Airport Terminal 2 bus pickup point: Bus pickup zone at the outdoor gallery at east side of 1F arrivals lobby.

From Taipei Songshan Airport

- Take the Taipei Metro **Wenhu Line (Brown)** at Songshan Airport Station to Daan Station, transfer to the Tamsui-Xinyi Line (Red) to Taipei 101/World Trade Center Station.



VISA Information

If you encounter any issues during your application, please consult or seek advice from your local embassy or overseas mission. They have the expertise and experience to handle visa-related matters efficiently to ensure a smooth process. To receive an invitation letter required for the visa application process, please complete the online registration via eBIS; the Secretariat of the 2025 IADI Taipei Events will then issue the letter based on your registration.

VISA-Exempt Entry

Duration of Stay	Nationalities
90 days	<p>Albania, Andorra, Australia, Austria, Belgium, Bulgaria, Canada, Chile, Croatia, Cyprus, Czech Republic, Denmark, Eswatini, Estonia, Finland, France, Germany, Greece, Guatemala, Haiti, Holy See, Hungary, Iceland, Ireland, Israel, Italy, Japan, Kosovo, Republic of Korea, Latvia, Liechtenstein, Lithuania, Luxembourg, Malta, Marshall Islands, Monaco, Netherlands, New Zealand, North Macedonia (effective until March 31, 2030), Norway, Palau, Paraguay, Poland, Portugal, Romania, San Marino, Slovakia, Slovenia, Spain, Sweden, Switzerland, Tuvalu, United Kingdom, United States of America.</p> <p>Nationals of Nicaragua, except those holding diplomatic or official/service passports, are eligible for the visa-exemption program, with a duration of stay of up to 90 days.</p> <p>Nationals of Honduras*, except those holding diplomatic or official/service passports, are eligible for the visa-exemption program, with a duration of stay of up to 90 days.</p>
30 days	<p>Belize, Malaysia, Nauru, Saint Kitts and Nevis, Saint Lucia, Saint Vincent and the Grenadines, and Singapore.</p> <p>Nationals of Dominican Republic, except those holding diplomatic or official/service passports, are eligible for the visa-exemption program, with a duration of stay of up to 30 days.</p>

Duration of Stay	Nationalities
14 days	<p>Nationals of the Kingdom of Thailand* (effective until July 31, 2026), except those holding diplomatic or official/service passports, are eligible for the visa-exemption program, with a duration of stay of up to 14 days.</p> <p>Nationals of Brunei* (effective until July 31, 2026), except those holding diplomatic or official/ service passports, are eligible for the visa-exemption program, with a duration of stay of up to 14 days. In addition, those holding a Brunei Certificate of Identity are eligible for the visa-exemption program, with a duration of stay of up to 14 days.</p> <p>Nationals of the Philippines* (effective until July 31, 2026), except those holding diplomatic or official/service passports, are eligible for the visa-exemption program, with a duration of stay of up to 14 days.</p>

* Please visit [here](#) for detailed requirements and the LATEST visa-exempt countries list.

eVISA

Passport holders of the following-mentioned nationalities are eligible for an eVisa.

Duration of Stay	Nationalities
90 days	<p>Bahrain, Bosnia and Herzegovina, Burkina Faso, Colombia, Dominica, Ecuador, , Kuwait, Mauritius, Montenegro, Oman, Panama, Peru, Qatar, Saudi Arabia, Solomon Islands, Turkey, United Arab Emirates</p> <p>*Note: Colombian nationals must provide a valid Schengen visa (or residence permit), a valid U.S. residence permit, or a U.S. visa with an expiration date of more than 180 days.</p>

* Please visit [here](#) for General Information on eVisa Application.

Accommodation

Main Hotel

Grand Hyatt Taipei



Welcome to Grand Hyatt Taipei – your home away from home in the heart of the city. Perfectly situated next to the world-renowned Taipei 101 and connected by a convenient skybridge, the hotel offers unmatched access to the Taipei World Trade Center and Taipei International Convention Center.

Set in the lively Xinyi District, one of Taipei' s most modern and welcoming neighborhoods, you will find themselves surrounded by a rich mix of fine dining, stylish shopping, and vibrant local culture. Whether you're exploring bustling night markets or relaxing with a view of the skyline, the area offers something for everyone. With nearby MRT stations and over 30 bus routes, getting around the city is easy—so you can focus on enjoying your time in Taipei.

- Check-in: 3:00 PM
- Check-out: 12:00 PM
- Tel: +886-2-2720-1234
- Address: No. 2, Songshou Road, Taipei 110061, Taiwan

To secure your room at the Grand Hyatt Taipei at the negotiated rate, please use the following link:
<https://www.hyatt.com/en-US/group-booking/TAIGH/G-CD25>

Attractions Near the Main Hotel

Landmarks

- Taipei 101 Observatory
 - National Dr. Sun Yat-Sen Memorial Hall
 - Songshan Cultural and Creative Park
-

Museums & Nature Spots

- Discovery Center of Taipei
 - Four Four South Village (aka Forty-Four South Village)
 - Xiangshan (Elephant Mountain) Hiking Trail
-

Shopping Locations

- Taipei 101 Mall
 - Shin Kong Mitsukoshi Department Store
 - Breeze atré
 - ATT 4 FUN
 - Bellavita
-

Night Markets

- Raohe Street Night Market
- Tonghua (Linjiang) Street Night Market



Social Events

Cocktail Party



Date: 9th September 2025

* This event is exclusive to invited guests.

Venue: YEN Bar (31F of W Taipei, 10 Zhongxiao East Road Sec. 5, Xinyi District, Taipei)

Assemble at East Entrance of Grand Hyatt Taipei.

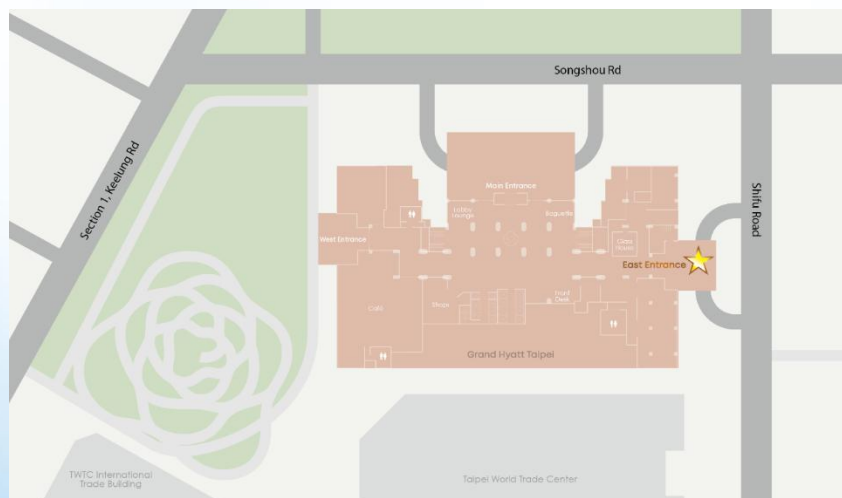

We warmly invite you to join us at YEN Bar, an iconic rooftop destination perched on the 31st floor of W Taipei. With sweeping views of Taipei 101 and the city skyline, YEN Bar offers a stylish setting where modern elegance meets vibrant energy. This cocktail reception is the perfect occasion to unwind, enjoy creative drinks, and connect with fellow guests in a relaxed yet sophisticated atmosphere.

Welcome Dinner



Date: 10th September 2025

Time: 18:30-21:30

Venue: Shangri-La Ballroom (2F of Shangri-La Far Eastern, 201 Tun Hwa South Road, Section 2, Taipei)

Assemble at East Entrance of Grand Hyatt Taipei.

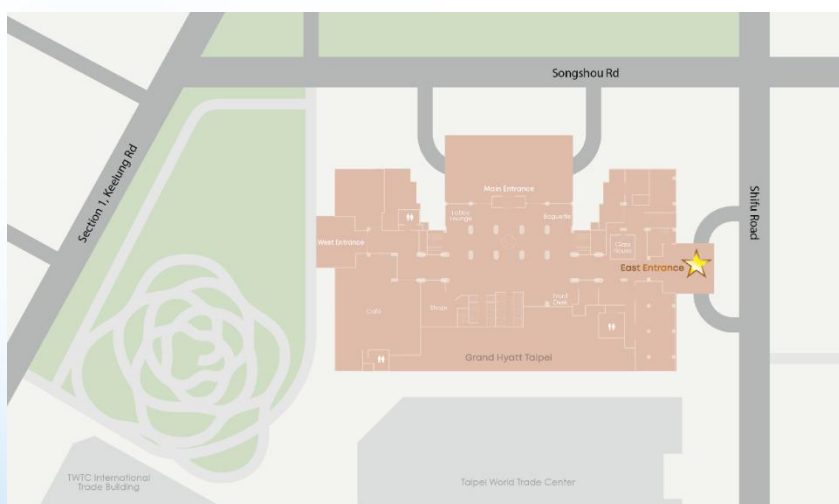

We warmly welcome you to an elegant evening at the Shangri-La Ballroom, where timeless sophistication meets warm hospitality. Set in the heart of Taipei, this welcome dinner offers the perfect setting to celebrate our gathering with fine cuisine, meaningful conversations, and a touch of festive charm. Gentle performances throughout the evening will add a special note to this heartfelt occasion. We look forward to sharing this memorable night with you.

Farewell Dinner



Date: 11th September 2025

Time: 18:30-21:30

Venue: Grand Ballroom I (3F of Grand Hyatt Taipei, Taipei)

Join us at Grand Ballroom I for a warm and graceful Farewell Dinner as we bring our time together to a meaningful close. You are invited to enjoy a final gathering filled with heartfelt conversations, exquisite cuisine, and light cultural performances that gently mark the end of this memorable journey. Let us celebrate the connections we' ve made and the experiences we' ve shared in this elegant and relaxed setting.

Excursion

Tour Itineraries

Where Artifacts Meet Landscapes: Exploring Northern Taiwan' s Rich Heritage

Date: 12th September 2025

Discover Northern Taiwan in a day where history, culture, and landscape meet. Begin at Mt. Bàoshí, a short yet scenic trail once used as a coastal lookout, now offering stunning views of the Yin-Yang Sea and surrounding peaks. Continue to the Gold Museum, Taiwan' s first eco-museum, preserving Jinguashi' s rich mining legacy. Enjoy lunch at the Grand Hotel' s Kunlun Room, followed by a walk through its Western Secret Passage. The day concludes with a visit to the National Palace Museum, a must-see for international visitors and home to one of the world' s finest collections of Chinese imperial artifacts. This thoughtfully curated journey offers a graceful glimpse into the cultural soul of Taiwan.

Jinguashi Baoshi Mountain Trill



Located in Ruifang District, New Taipei City, Mt. Baoshi (also known as Mt. Shuǐluó) stands at 260 meters. Once home to a wartime alarm system, it now features one of Taiwan' s shortest scenic trails. A 10-minute walk leads to a viewing platform overlooking the Yin-Yang Sea, with stunning 360° views of Jiufen, Jinguashi, and surrounding peaks.

Jinguashi Gold Mine Museum

Gold Mine Museum blends the rich heritage of gold mining with the serene beauty of Jinguashi' s misty mountains. As Taiwan' s first eco-museum, it weaves together historic mining trails, relics, and hillside architecture to tell the story of a once-thriving community—where nature, memory, and industry quietly coexist.



National Palace Museum



Home to one of the world' s finest collections of Chinese imperial artifacts, the National Palace Museum offers a breathtaking journey through over 8,000 years of history. From jade carvings to ancient calligraphy, each piece tells a story of dynasties past and cultural treasures preserved.

Grand Hotel Taipei

Experience the timeless charm of the Grand Hotel, one of Taipei' s most iconic landmarks. Enjoy lunch in the Kunlun Room, where large windows offer sweeping views of the city skyline in an elegant and serene setting..



Time	Itinerary
07:50-08:00	Assemble at East Entrance of Grand Hyatt Taipei.
08:00-09:30	Transfer Time
09:30-10:30	Jinguashi Baoshi Mountain
10:30-11:30	Jinguashi Gold Mine Museum
11:30-13:00	Transfer Time
13:00-14:30	Lunch at Kun Lun Room , Grand Hotel Taipei
14:30-15:00	Free exploration in Grand Hotel Taipei
15:00-15:30	Transfer Time
15:30-17:00	Visit National Palace Museum
~17:30	Return to Taipei City

Meeting Points and Times

Date: 12th September 2025

Time: 7:50-8:00

Meeting point: Lobby Floor of Grand Hyatt Taipei

Important Notes

- Comfortable walking shoes are recommended, especially for navigating Jinguashi.
- Museum galleries are air-conditioned; a light jacket is recommended.
- The itinerary may be adjusted slightly due to weather or traffic conditions.
- Guests are encouraged to bring water, a raincoat or umbrella, and any personal medication.

Travel to Taipei

Practical Information

■ Climate

Northern Taiwan has a subtropical climate. Daytime temperatures in Taipei in September typically reach around 31°C (88°F), with evening temperatures dropping to approximately 26°C (79°F).

Participants are advised to bring light, breathable clothing and an umbrella or raincoat, as short afternoon showers are common during this month.

■ Currency

The official currency of Taiwan is the New Taiwan Dollar (NTD), available in the following denominations:

Coins: \$1, \$5, \$10, \$50

Notes: \$100, \$200, \$500, \$1000

Almost all vendors in Taipei accept cash. Most shops, hotels and restaurants also accept major credit cards (Visa, Mastercard, JCB, UnionPay), but not traveler' s cheques. As of May 2025, the exchange rates are approximately USD 1 to NTD 30 and EUR 1 to NTD 34. Be sure to check out the latest rates.

Banks operate on Monday to Friday (except public holidays) from 09:30 to 15:30. You may exchange currency at airports, banks and post offices; but don' t forget to bring your passport with you. You can also use your domestic credit or debit card to withdraw NTD from ATMs across Taiwan. Check with your card issuers in advance.

■ Language

The official language in Taiwan is Mandarin. While English is widely spoken and the Taiwanese are known for their friendliness, it is generally easy to ask for help or clarify directions. Most signs for destinations and on public transportation are also in English.

We recommend carrying Mandarin translations of the places you plan to visit, as well as a hotel address card to show to taxi drivers, who may have limited English proficiency.

■ Smoking Policy

Smoking is prohibited in all indoor, most public places, the Mass Rapid Transit (MRT) stations, and bus stops. Please pay attention to non-smoking signs.

■ Electricity & Plug

Electric current of 110 volts at 60 cycles is used.

Participants from Europe, Australia or South-East Asia will need an adaptor or transformer

■ Time Difference

Taipei is 8 hours ahead of GMT.

Public Transportation

■ Getting from/to the Airports

There are two international airports serving Taipei:

Taoyuan International Airport (TPE)

- The most convenient airport for traveling to Taipei.
- Offers regular scheduled flights from major international airlines.
- Located approximately 50 kilometers from Grand Hyatt Taipei and Taipei 101.
- Recommended: Taxi or airport shuttle for the most direct and seamless way to reach Xinyi District.

Taipei Songshan Airport

- Primarily serves destinations in Taiwan and other locations in Asia (e.g., Seoul, Tokyo, mainland China).
- Located less than 20 minutes by car to Grand Hyatt Taipei and Taipei 101.
- More conveniently located than Taoyuan Airport.

■ Public Transportation in Taipei

TAXI

- In Taiwan, taxis are yellow and widely available at taxi ranks, hotels, and airports.
- Taxis can also be hailed on the streets of Taipei City.
- Uber is available as well.
- Estimated fares:
 - Taoyuan Airport → Taipei City: ~NT\$1,200
 - Songshan Airport → Taipei City: ~NT\$500

BUS

- Taipei buses **cover the entire city** and are a great way to explore in depth.
- Fares:
 - Payable in **coins** or using the **EasyCard** (electronic travel card)
 - One trip costs **NT\$15**
- When using the EasyCard:
 - Tap the card **when boarding and alighting**
 - Fare will be deducted accordingly
- For more information: [View bus routes](#)

METRO (MRT)

- Often the **fastest and most convenient** mode of transport in Taipei
- Train frequency: Every **3 to 5 minutes**
- Average travel time between stations: **~2 minutes**
- **Not allowed inside the metro:** Smoking, eating, drinking, chewing gum
- Ticketing:
 - One-way tickets from vending machines
 - Day passes and **EasyCard** available at MRT information desks

For more info:

- [\[Metro Taipei \(MRT\)\]](#)
- [\[Metro Taoyuan \(MRT\)\]](#)

YOUBIKE (Public Bike Sharing)

- Integrated with the MRT network
- YouBike stations are located **outside every MRT station** and near most major sites in Taipei

For more info:

- [\[YouBike Official Website\]](#)

Discover Taipei

Taipei City is the capital of the Republic of China (Taiwan). It is located in northern Taiwan, including the northeastern part of the Taipei Basin and the surrounding hilly region. Taipei is the development center of Taiwan in the fields of politics, economy, education, and culture. It is also one of the main hubs in East Asia.

Taipei City has a long history and culture and is rich in humanities and arts. The culture and education, friendly diplomatic relations, and multi-ethnic integration enrich the diversity of Taipei. The advances in economic development and the robust transportation systems also draws overseas travelers to visit, do business, stay and study in the city.

Must visit in Taipei City

Taipei 101 Observatory

- A great spot for a night view!
- The **outdoor observation deck on the 91st floor** is the sky grassland picnic site, where you can enjoy a relaxing "Sky Tour" at an altitude of 400 meters above sea level.
- Once **the world's tallest building**, Taipei 101 remains a **must-see attraction** for anyone visiting the capital of Taiwan.

[View more information](#)



Shilin Night Market

- A great spot for meals and snacks.
- One of the **largest and most popular night markets** in Taiwan.
- A maze of alleyways filled with a diverse range of local, traditional, and international merchandise.
- Vibrant and bustling atmosphere that attracts both locals and foreigners.

[View more information.](#)



Dadaocheng and Dihua Street

- An excellent location for a leisurely stroll.
- **Dihua Street**, part of the **Dadaocheng** precinct, was established in the 1850s.
- In the past, it was a key trading port for groceries, tea leaves, fabric, Chinese medicine, etc.
- Today, it' s a popular destination known for its **retro street views** and **local specialties**.

[View more information](#)



Tonghua (Linjiang) Street Night Market

- A great spot for meals and snacks.
- Located between **Tonghua Street** and **Keelung Road**, about 300 meters long.
- Over 200 food stalls.
- Famous for **dry noodles**, **oyster omelets**, **sausages**, **braised meat**, and more.

[View more information](#)



Tour Service

For assistance during your stay in Taiwan, the toll-free Tourist Hotline (0800-011-765) is available 24 hours a day, offering support in Mandarin, English, Japanese, and Korean.

In addition to answering general travel inquiries, the hotline provides itinerary planning assistance, including destination recommendations, transportation guidance, and travel time estimates. Whether you're planning a day trip, visiting regional attractions, or navigating city routes, trained staff are ready to help you make your journey smoother and more efficient.

For more travel information, please visit the following websites:

1. Taiwan Tourism Portal: <https://eng.taiwan.net.tw/m1.aspx?sNo=0029016>
2. Taipei City Tourism Portal: <https://www.travel.taipei/en>
3. New Taipei City Tourism Portal: <https://newtaipei.travel/en>

If you experience any difficulty contacting the above parties, please feel free to reach out to us using the information below for further assistance.

Secretariat of the 2025 IADI Taipei Events

Phone: +886 2 8780-5688 #161

E-mail: secretariat@iadi2025taipei.org



2025 IADI

Ad hoc Executive Council Meeting
and Core Principles Conference
9th-12th September 2025



中央存款保險公司
Central Deposit Insurance Corporation